

## DETAILED PARTS AND ASSEMBLY PROCEDURE

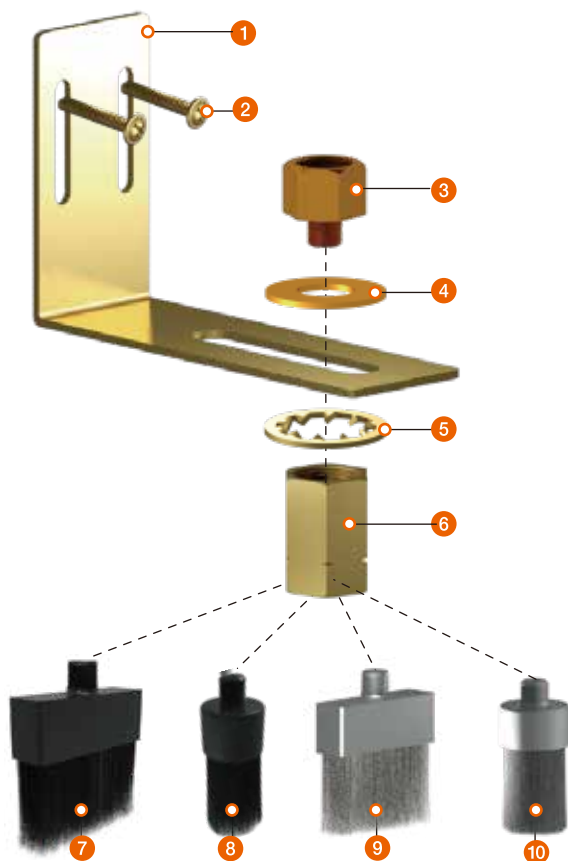

LIST	PART No.	DESCRIPTION	Q'TY
①	B003	Oil Brush Bracket, "L"Shape	1
②	B051	Self Drilling Screw, #8 x 20	2
③	A002	Reducer, 3/8"F X 1/8"M Adaptor	1
④	B057	Washer	1
⑤	B058	Tooth Washer	1
⑥	C012	Socket, PT1/8"F x NPT1/8"F	1
⑦	C001	Oil Brush, 2" Flat Nylon, NPT1/8"M	1
⑧	C002	Oil Brush, 1" Round Nylon, NPT1/8"M	1
⑨	C013	Oil Brush, 2" Flat Stainless Steel, NPT1/8"M	1
⑩	C014	Oil Brush, 1" Round Stainless Steel, NPT1/8"M	1

### ASSEMBLY PROCEDURE

1. Install the mounting bracket ( ① ) in an appropriate location using the screws ( ② ).
2. Fasten the reducer ( ③ ), washer ( ④ ), socket ( ⑥ ), tooth washer ( ⑤ ) and brush ( ⑦ ~ ⑩ ) in the desired position along the slot of the bracket.  
Make sure the socket is assembled as pictured. The line around the socket should be facing downward as that end will connect to the NPT thread of the brush.  
The other end of the socket is PT.

### COMMENTS

1. Apply PTFE tape around the thread of the brush ( ⑦ ~ ⑩ ).
2. Output volume may vary depending on oil viscosity, ambient temperature, etc.

LIST & PART No.	KIT No.	DESCRIPTION
[ ① ~ ⑥ ] + ⑦ (C001)	<b>C030</b>	Flat Nylon Brush Kit for Pulsarlube OL500
[ ① ~ ⑥ ] + ⑧ (C002)	<b>C031</b>	Round Nylon Brush Kit for Pulsarlube OL500
[ ① ~ ⑥ ] + ⑨ (C013)	<b>C032</b>	Flat Steel Brush Kit for Pulsarlube OL500
[ ① ~ ⑥ ] + ⑩ (C014)	<b>C033</b>	Round Steel Brush Kit for Pulsarlube OL500