

DETAILED PARTS AND ASSEMBLY PROCEDURE

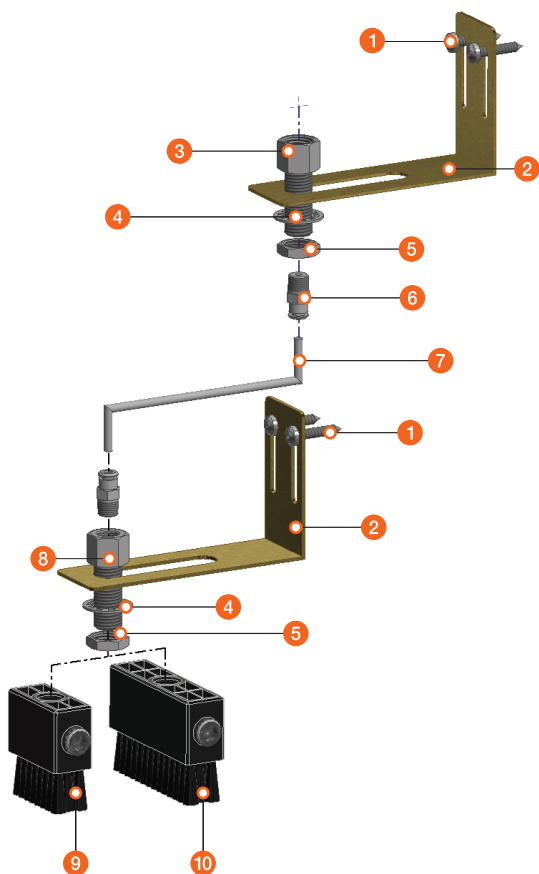

LIST	PART No.	DESCRIPTION	Q'TY
1	B051	Self Drilling Screw, #8 x 19, Steel	4
2	B003-01	Oil Brush Bracket, "L" Shape, Steel	2
3	A315	Reducer, PT3/8" F x PF1/4" Mx30mm x PT1/8" F, Steel	1
4	B058	Tooth Washer, O.D.23mm x I.D.14.5mm x 1t, Steel	2
5	N001	Nut, PF1/4" F x 5mm, Steel	2
6	A317	One-Touch fitting, Ø4 x PT1/8" M, Nickel Plated	2
7	C021-1	Nylon Tube, 3m (10ft) O.D. 4mm x I.D. 2.5mm	1
8	A316	Reducer, PT1/8" F x PF1/4" M x 25mm Adaptor, Steel	1
9	C017	Oil Brush, 45 x 20 x 30mm Flat Nylon, PF1/4" F	1
10	C018	Oil Brush, 74 x 20 x 30mm Flat Nylon, PF1/4" F	1

ASSEMBLY PROCEDURE

1. Install the Oil Brush Bracket (2) in an appropriate location using the Self Drilling screws (1).
2. Fasten the Reducer (3), Tooth washer (4), Nut (5) and One-Touch fitting (6).
3. Install another Oil Brush Bracket (2) in an appropriate location using the Self Drilling screw (1) to remote install.
4. Fasten the Tooth washer (4), Nut (5), Reducer (8) and One-Touch fitting (6). Connect each end of the Nylon Tube (7) to both One-Touch fittings (6).
5. Connect the appropriate brush (9) or (10) to the thread of the Reducer (8).

COMMENTS

Output volume may vary depending on oil viscosity, ambient temperature, etc.

LIST & PART No.	KIT No.	DESCRIPTION
[1 ~ 8] + 9 (C017)	C046	[OL] Remote Installation & 45mm Oil Brush Kit
[1 ~ 8] + 10 (C018)	C047	[OL] Remote Installation & 74mm Oil Brush Kit